

 SILVERSEA®

The SilverSea logo consists of a stylized, geometric icon resembling a compass rose or a ship's wheel, followed by the brand name 'SILVERSEA' in a serif font with a registered trademark symbol.

East **FAR** West

Broaden your horizons

2024 WORLD CRUISE | SAN FRANCISCO - SAN FRANCISCO | 15 JAN - 26 MAY 2024

 SILVERSEA®

East FAR West

Broaden your horizons



Whittier
Cruising Hubbard Glacier
Icy Strait Point
Juneau
Tracy Arm / Sawyer Glacier
Sitka
Wrangell
Ketchikan
Prince Rupert

Vancouver
Victoria

San Francisco

Nawiliwili
Honolulu
Kailua-Kona
Christmas Island

Apia
Savusavu

Lautoka

Petropavlovsk

Korsakov

Vladivostok

Otaru

Aomori

Akita

Tokyo

Osaka

Hiroshima

Beijing (Tianjin)

Shanghai

Hong Kong

Hue/Da Nang (Chan May)

Ho Chi Minh City

Kota Kinabalu

Singapore

Kuching

Borobudur (Semarang)

Bali (Benoa)

Lembar

Komodo Island

Darwin

Thursday Island

Cairns

Broome

Airlie Beach

Fraser Island

Mooloolaba

Brisbane

Sydney

Eden

Bay of Islands

Auckland

Gisborne

Napier

Wellington

Tauranga

Nelson

Kaikoura

Akaroa

Uluru



BROADEN YOUR HORIZONS

How far will you go to broaden your horizons? Welcome to our 2024 World Cruise, a journey that will push your travel boundaries farther than ever before. This 132-night voyage explores our planet's most extraordinary destinations, weaving a story of Pacific heritage as it unfolds. Join us and learn how East and West have fused together for millennia, through their changing customs, cuisines and cultures. This is a voyage for those who want to experience the very extremes of the planet. It's time to get out there and go beyond what you thought possible. It's time to broaden your horizons.

1 REMOTE ISLANDS OF THE PACIFIC



GOLDEN GATE BRIDGE, SAN FRANCISCO, U.S.A.

Sometimes a journey begins best when one takes the road less travelled. Drink your fill of vitamin sea as we sail to the pearls of Polynesia, where sculpted mountains plunge into sapphire seas and where one island is never enough. Say “aloha” to life in the slow lane in Hawaii before your visit to the cradle of Polynesia – Apia, in Samoa – teaches you the history of why these islands are paradisiacal paradoxes.



OAHU COASTLINE IN HONOLULU, HAWAII

HONOLULU (HAWAII) / 21-22 January

Sitting at the southeastern tip of Oahu, the iconic capital of Hawaii is an urban explorer's dream. From its extensive beaches and unique Arts District to its vibrant waterfront and world-class attractions, Honolulu charms you like no other world capital. Our exclusive event onboard the Battleship Missouri in Pearl Harbour rounds out your visit for a truly unforgettable experience.



LIGHTHOUSE AT NAWILIWILI HARBOR, HAWAII

NAWILIWILI (HAWAII) / 23 January

Surrounded by lush green hills and valleys, the Hawaiian harbour of Nawiliwili is a place where nature still reigns supreme and time drips by slowly. Located on the enchanting island of Kauai, the area surrounding the port offers up a series of captivating hiking trails with incredibly breathtaking panoramas, stunning waterfalls and photography-worthy landscapes.



SAMOA ISLAND, POLYNESIA

APIA (SAMOA) / 02 February

Known as the “cradle of Polynesia”, Samoa is located at the crossroads of the Pacific and, indeed, of history. A key island for ocean exploration, its capital Apia is nestled in a paradise of serene hills and beautiful seafront, including Vaiala Beach and a stretch of coral reef, as traditional Samoan houses stand side by side with 19th century churches and a gorgeous clock tower.

EXCLUSIVE WORLD CRUISE EVENT

AN EVENING ON THE USS MISSOURI

21 JANUARY 2024 - HONOLULU, OAHU (HAWAII)

Step back into the past and celebrate history with your fellow travellers during an unforgettable evening at the U.S.S. Missouri in Pearl Harbour. You'll enjoy a Hawaiian welcome and bespoke dinner in full view of this majestic icon of the seas, accompanied by nostalgic music of the likes of the Andrews Sisters.



USS ARIZONA AND USS MISSOURI MEMORIALS IN FORD ISLAND, PEARL HARBOR, HAWAII

2 NEW ZEALAND FAR AND WIDE



AKAROA VILLAGE ON BANKS PENINSULA, NEW ZEALAND

Flanked by two very different but equally amazing countries, this voyage is all about New Zealand's Māori culture and epic "Lord of the Rings" landscape. Sailing a new route from Fiji, Silver Shadow embraces the west coast of both islands, stopping in iconic and off-the-beaten-track ports on the way. If you've ever wanted to explore the vast wealth of Kiwi culture, now is your chance.



LAUTOKA, FIJI

LAUTOKA (FIJI) / 05-06 February

Lie back and relax as you enjoy the crystal clear waters and picturesque white sand beaches off the west coast of Viti Levu, in the Fiji Islands. Explore areas dotted with traditional thatched huts and verdant landscapes as you stroll in and around the country's second largest city, Lautoka, also known as Sugar City for its vast sugar cane fields stretching as far as the eye can see.



BAY OF ISLANDS, NEW ZEALAND

BAY OF ISLANDS (NEW ZEALAND) / 09 February

One of New Zealand's most iconic destinations, the Bay of Islands will captivate you with its turquoise waters and over 140 different islands that are largely untouched and uninhabited. These islands have welcomed explorers of all stripes over the centuries, from the first Māori settlers to more recent permanent British settlements, for a melting pot of customs, traditions and cultures.



SKYLINE OF AUCKLAND, NEW ZEALAND

AUCKLAND (NEW ZEALAND) / 10-11 February

Auckland, or Tāmaki Makaurau as its known in Māori, is New Zealand's multicultural and multifaceted capital, a green and gorgeous city sprawled across two harbours and 48 volcanic cones that create a unique urban landscape. You'll be immersed in lush native rainforests, rolling hills, dramatic black sand beaches and tranquil bays for a city visit like no other.

3 THE LANDS DOWN UNDER



SYDNEY HARBOUR, AUSTRALIA

Australia is the country that just keeps on giving, whether this is your first or fiftieth visit. This is where millennial cultures meet cosmopolitan cool, where the kaleidoscopic marine life of the Great Barrier Reef meets the ochre plains of Uluru and the red rocks of The Kimberley. Join us as we sail the craggy north coast from Sydney to Bali and prepare for a real taste of the unexpected.



THURSDAY ISLAND, TORRES STRAITS, AUSTRALIA

THURSDAY ISLAND (AUSTRALIA) / 05 March

Set among 273 other small islands in the remote Torres Strait archipelago, Thursday Island is home to a small number of indigenous Torres Strait Islanders. With a population of just over 2,000, it's a tropical paradise like no other, with a laid-back atmosphere that immediately puts you at ease and in the right frame of mind to enjoy the island's pristine waters and lush vegetation.



BROOME, AUSTRALIA

BROOME (AUSTRALIA) / 11-12 March

Located along Australia's wild and untouched Kimberley Coast, Broome will welcome you with stunning beaches and picturesque bays that feature clear turquoise waters and fine sand beaches. Explore the area a little and you'll soon encounter flora and fauna like nowhere else, as the Kimberley region is one of the most unspoiled and uninhabited places in the world.



LOCAL FISHERMAN, INDONESIA

LEMBAR, LOMBOK (INDONESIA) / 15 March

A first for our World Cruise, visiting Lembar Lombok is like stepping into another world. A neighbour of Bali, it shares a similar natural beauty, including pristine beaches and crystal clear waters, while it also showcases the deep Indonesian culture of the area and has a slightly more international feel as a bustling port city with travel in its veins.

EXCLUSIVE WORLD CRUISE - OVERLAND PROGRAMME

A UNIQUE NIGHT OF MAGIC AT ULURU

8-9 MARCH 2024 - ULURU (AUSTRALIA)

Right at the heart of Australia is Uluru, a solitary mountain with desert stretching out away from it as far as the eye can see. The spiritual center for the indigenous population, we'll be treated to a special cultural and dinner event, along with one of the starriest night skies in the world.



4 TEMPLES OF A DISTANT PAST



TRADITIONAL HINDU GATE IN BALI, INDONESIA

The exotic lyricism of Southeast Asia is fabled across the world. Travel far into the heart of wide-ranging coastal cultures, from Bali all the way to Hong Kong. This journey truly embodies the mind, spirit and soul of the region: from the dazzling dichotomy of Singapore to the extraordinary wildlife of Borneo and the happy cacophony that is Ho Chi Minh City. This is where we dive underneath the surface of a truly authentic Asia.



GARDENS BY THE BAY, SINGAPORE

SINGAPORE (SINGAPORE) / 22-23 March

A melting pot of cultures, influences and stories, Singapore's sparkling skyline is home to one of the hottest destinations in Asia. We'll dock right in the middle of the harbour, amongst the many high rises dotting its waterfront, to enjoy all the great food, hospitality, entertainment, culture and nightlife this worldly city has to offer.



HO CHI MINH CITY CENTER AND SAIGON BRIDGE, VIETNAM

HO CHI MINH CITY (VIETNAM) / 29-30 March

We'll continue to cover great distances as we visit Vietnam's most iconic city, Ho Chi Minh. An urban collage full of contrasts, you'll wander alleyways full of small shops and street food stalls to then be surrounded by the smell of incense at any of the city's many ancient temples. A blend of local traditions and French flair round out this historical tapestry of ideas and influences.



PRAYER STICKS INSIDE TEMPLE, HONG KONG

HONG KONG (CHINA) / 03-05 April

You'll come for the shopping and stay for the tea, as you explore a unique city where yesterday and tomorrow meet. We'll enjoy an extended stay to discover as many hidden streets, restaurants and tea parlours as possible and explore the city's beautiful waterfront. A multicultural treasure, this is where you'll find some of the world's best sightseeing, cuisine and nightlife.

EXCLUSIVE WORLD CRUISE - OVERLAND PROGRAMME

WHERE MAJESTIC TEMPLES MEET

19-20 MARCH 2024 - SEMARANG, JAVA (INDONESIA)

Visit the Hindu temple of Prambanan and Buddhist temple of Borobudur on Java, both UNESCO World Heritage Sites. A one night overland gives us the chance to see both impressive attractions, including a sunset dinner event at Prambanan with the temples lit up magically at night.



5 WHERE EAST MEETS WEST



Located on the ancient spice route and bathed in traditional culture, Japan and China will excite even the most jaded of travelers. Overnights in all destinations offer in-depth onshore exploration, allowing you to travel further in the Far East than ever before. Yet heritage is only half the story here; think inspiring modern art, vibrant design and celebrated gastronomy that defines two indefinable countries.



BEIJING (CHINA) / 13-14 April

With a history spanning three millennia, Beijing is China. With a mix of new and old, it takes you far back in time to delight you with a rich blend of things to see, eat and do. From squares to palaces to temples to museums it's an assault on the senses with never enough time to see it all. It's a taste of the authentic China, from cuisine to culture and beyond.



HIROSHIMA (JAPAN) / 17 April

We begin our exploration of Japan (a World Cruise first) with this captivating historical city and its breathtaking views and incredible sites, including Hiroshima Castle and Peace Memorial Museum. Miyajima, also known as Shrine Island is famous for its spectacular Itsukushima shrine that, at high tide, appears to actually levitate.



TOKYO (JAPAN) / 20-21 April

The largest city in the world, Tokyo is a shiny, sparkling, bustling hub of yesterday and tomorrow, as neon-lit skyscrapers and billboards light up the sky and also many of the city's historic temples. From world-class Japanese cuisine to trendy fashion centres to centennial traditions like Kabuki theatre and more, Tokyo has something for absolutely everyone.

EXCLUSIVE WORLD CRUISE EVENT

THE PAST AND FUTURE IN COLOUR

08 APRIL 2024 - SHANGHAI (CHINA)

Enjoy a unique subversive dining experience in a secret location specially created just for you. You'll go on a culinary journey from old Shanghai to modern China bathed in colour, sound and scent, for a truly unforgettable evening.



SKYLINE AND THE HUANGPU RIVER IN SHANGHAI, CHINA

6 A BRIDGE ACROSS TIME



HUMPBACK WHALE IN KODIAK, ALASKA

Budding explorers, it's your time to shine! Go deeper than ever before on a world cruise and join the ranks of the (very) well-travelled by crossing the Bering Sea. But first, finish your exploration of Japan with a semi circumnavigation of the island before sailing to the remote Russian Far East. Underscored by rich culture and masses of charisma, this trip is for those who are ready to brave the forces of nature.



AOMORI (JAPAN) / 23 April

Upon arrival to Aomori you'll marvel at the unusual beauty of Aomori Bay with its singular skyline that includes a triangular-shaped tourist center and bridge. A sparkling waterfront will welcome you to this distant pristine outpost that is home to beautiful water gardens, unique architecture and a startling number of parks and museums. A real hidden gem of the far north of Japan.

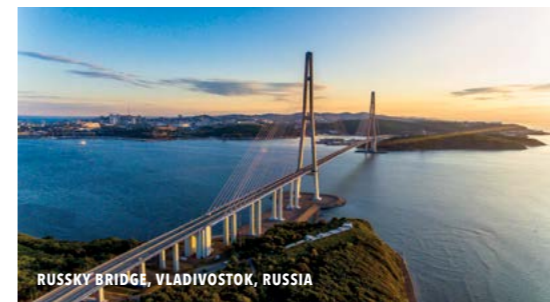

VLADIVOSTOK (RUSSIA) / 27-28 April

This remarkable and secret city has always represented the Russian Far East, an extreme of the extremes as it has served as an eastern marker for the country since Czarist times. Full of a history that spans multiple centuries, you'll enjoy both the ancient and modern parts of the city, including cuisine and culture you'll experience nowhere else on the planet.



PETROPAVLOVSK (RUSSIA) / 03-04 May

The gateway to the remote and mysterious Kamchatka region, Petropavlovsk is an explorer's dream, with its rugged natural beauty and magical picturesque landscape. The second largest city in the world unreachable by road, it's a port city like no other, and features fascinating churches, museums and restaurants that will pique your curiosity about this fascinating land.

EXCLUSIVE WORLD CRUISE EVENT - FULL SHIP

A NIGHT AT THE RUSSIAN OPERA

27 APRIL 2024 - VLADIVOSTOK (RUSSIA)

Take your seat in front of the stunning Primorsky Stage of the Mariinsky Theatre and you'll immediately be transported to another place and time as you enjoy a dedicated performance in the world's northernmost opera house. Enjoy pre-show and intermission caviar and champagne for a night like no other.



RUSSIA GOLDEN HORN BRIDGE, VLADIVOSTOK, RUSSIA

EXCLUSIVE WORLD CRUISE EVENT - FULL SHIP

RUSSIAN TRADITION IN KORSAKOV

30 APRIL 2024 - KORSAKOV (RUSSIA)

Cultures come together at this special event that immerses you in tradition and welcomes you in true Russian style. Discover flavours and folklore, including a Cossack performance, and experience how western and eastern influences have shaped this remote part of the country.



FOLKLORE GROUP OF RUSSIAN DANCERS

SAILING THE FAR WEST



HUBBARD GLACIER, ALASKA

Alaska offers to curious cruisers the very best of our planet: mountainous peaks reaching for the heavens, a vibrant heritage that dates back centuries, and abundant wildlife so diverse nothing will ever seem the same again. This profound voyage not only delivers one of the last, authentic travel experiences, but is a fitting finale for those who have come from afar to broaden their horizons amid like-minded friends.



ICY STRAIT POINT, ALASKA

ICY STRAIT POINT, ALASKA (U.S.A.) / 13 May

Explore a different side of America as you go back in time to this small point of westernmost Alaska that features a rich mix of Russian, US and indigenous influences, including Native Tlingit culture and hospitality. From bear-spotting to whale-watching to trail hiking, you'll be amazed by the singular wilderness of this remote coastal town.



SNOWCAPPED MOUNTAINS IN JUNEAU, ALASKA

JUNEAU, ALASKA (U.S.A.) / 15-16 May

A frontier town in ways more than one, Juneau is the northernmost US state capital and is the only one located on an international border, with Canada right to the east. Incredible wildlife, both on land and at sea, makes this a fantastic place to visit, as does its vibrant downtown with its old storefronts and quaint 19th century houses left over from the town's early gold rush days.



BRITISH COLUMBIA PARLIAMENT, VICTORIA, CANADA

VICTORIA (CANADA) / 21 May

Our last stop before returning to San Francisco, the enthralling city of Victoria sits at the southernmost tip of Vancouver Island and is the capital of the Canadian province of British Columbia. An incredibly picturesque city, it's surrounded by gorgeous mountain and ocean views, with a beautiful harbour, lovely gardens, quaint boutiques and historic tearooms.



A COMPLIMENTARY EXCURSION IN EVERY PORT

Enjoy a complimentary shore excursion in every single port of call throughout the entire 2024 World Cruise. Choose from a selection of over 200 included excursions across the whole itinerary, including day trips suited to those visiting a destination for the first time and uniquely curated experiences for the well-travelled.

WORLD CRUISE COLLECTION SHORE EXCURSIONS

Enjoy a selection of bespoke shore excursions

Our World Cruise Collection shore excursions are the perfect way to gain an in-depth understanding and a unique view of the most wonderful places we will visit. From Brisbane to Shanghai to Petropavlovsk and more, these curated onshore experiences enrich your spirit and your knowledge via private tours that awe and inspire. With select experts rich in local knowledge, you'll find out all the intricate details of each of these fascinating destinations.



BLACK SPOTTED EAGLE RAYS SWIMMING OVER THE CORAL REEF

MANTA RAYS & LADY ELLIOTT ISL.
26 FEBRUARY 2024
Brisbane

Experience a full-day tour of Lady Elliott Island and the Southern Great Barrier Reef, both in the water and above it. See the coral reef up close and swim with an amazing array of marine life, including the island's famous Manta Rays.



THE BUND, SHANGHAI, CHINA

PEACE HOTEL & OLD JAZZ BAR
09 APRIL 2024
Shanghai

Enjoy a unique perspective and a deep dive into the rich history, background and architecture of both the wonderful Fairmont Peace Hotel and fascinating Old Jazz Bar in Shanghai with Architecture Expert Patrick Cranley.



AVACHINSKY VOLCANO, KAMCHATKA, RUSSIA

VOLCANO & HOT SPRINGS
03 MAY 2024
Petropavlovsk

Take a magnificent helicopter ride over the remote Kamchatka Peninsula and its volcanic landscapes, all the way to the slopes of the Avachinsky Volcano. Then travel onwards to the Nalychevo valley to bathe in the area's wild hot springs.

Our exclusive OVERLAND PROGRAMMES

Discover our selection of bespoke overland tours

For our 2024 World Cruise, we've curated a unique series of customised overland programmes created to take you farther than ever before. These exclusively designed tours get you deep into the destination and offer you a chance to experience the best of the best in authentic travel. See the most beautiful parts of New Zealand in a single tour, visit the largest remote monastery in the world in Tibet, or go deep into the wilderness of Alaska for a private chalet stay like no other. Wherever you go overland, it will truly be a once-in-a-lifetime experience.



THE ULTIMATE NEW ZEALAND
12-16 FEBRUARY 2024
New Zealand

See the most beautiful sites of this remote country during this scenic overland tour. Visit an olive mill and vineyard for tastings, explore unique geothermal landscapes, see the world-famous Milford Sound and travel to an authentic Māori village.



THE ROOF OF THE WORLD
9-13 APRIL 2024
Tibet

Experience the spiritual center of Tibet by visiting the Drepung Monastery. The world's largest, with a population of over 10,000 practising monks, it will welcome you with a unique window into the traditional monastic lifestyle of this area.



THE GREAT ESCAPE
7-11 MAY 2024
Alaska

Enjoy a spectacular helicopter ride to Alaska's Sheldon Chalet, just 10 miles from the summit of the magnificent Ruth Glacier. Award-winning cuisine and pure luxury await you in this exclusive private chalet nestled in a majestic setting.

MONDAY, 15 JANUARY 2024, EMBARK SILVER SHADOW

DATE	PORTS	ARRIVE	DEPART
CHAPTER 1			
15 Jan	SAN FRANCISCO		19:00
16 Jan	DAY AT SEA		
17 Jan	DAY AT SEA		
18 Jan	DAY AT SEA		
19 Jan	DAY AT SEA		
20 Jan	DAY AT SEA		
21 Jan	HONOLULU	08:00	☾
22 Jan	HONOLULU		18:00
23 Jan	NAWILIWILI	08:00	17:00
24 Jan	KAILUA-KONA	09:00	21:00
25 Jan	DAY AT SEA		
26 Jan	DATE LINE LOSE A DAY		
27 Jan	DAY AT SEA		
28 Jan	DAY AT SEA		
29 Jan	CHRISTMAS ISLAND	08:00	18:00
30 Jan	DAY AT SEA		
31 Jan	DAY AT SEA		
1 Feb	DAY AT SEA		
2 Feb	APIA	08:00	18:00
3 Feb	DAY AT SEA		
4 Feb	SAVUSAVU	08:00	18:00
CHAPTER 2			
5 Feb	LAUTOKA	07:00	☾
6 Feb	LAUTOKA		13:00
7 Feb	DAY AT SEA		
8 Feb	DAY AT SEA		
9 Feb	BAY OF ISLANDS	09:00	18:00
10 Feb	AUCKLAND	08:00	☾
11 Feb	AUCKLAND		18:00
12 Feb	TAURANGA	08:00	18:00
13 Feb	GISBORNE	09:00	18:00
14 Feb	NAPIER	08:00	17:00
15 Feb	WELLINGTON	08:00	18:00
16 Feb	AKAROA	08:00	22:00
17 Feb	KAIKOURA	08:00	18:00
18 Feb	NELSON	08:00	18:00
19 Feb	DAY AT SEA		

20 Feb	DAY AT SEA		
21 Feb	DAY AT SEA		
22 Feb	EDEN	08:00	19:00
23 Feb	SYDNEY	12:00	☾
CHAPTER 3			
24 Feb	SYDNEY		19:00
25 Feb	DAY AT SEA		
26 Feb	BRISBANE	08:00	23:00
27 Feb	MOOLOOLABA	07:00	17:00
28 Feb	FRASER ISLAND	09:00	18:00
29 Feb	DAY AT SEA		
1 Mar	AIRLIE BEACH (WHITSUNDAY ISLANDS)	08:00	17:00
2 Mar	CAIRNS	13:30	☾
3 Mar	CAIRNS		22:00
4 Mar	DAY AT SEA		
5 Mar	THURSDAY ISLAND	08:00	18:00
6 Mar	DAY AT SEA		
7 Mar	DAY AT SEA		
8 Mar	DARWIN	08:00	☾
9 Mar	DARWIN		17:00
10 Mar	DAY AT SEA		
11 Mar	BROOME	12:00	☾
12 Mar	BROOME		13:00
13 Mar	DAY AT SEA		
14 Mar	KOMODO ISLAND	08:00	13:00
15 Mar	LEMBAR	08:00	19:00
16 Mar	BENOA, BALI	07:00	☾
CHAPTER 4			
17 Mar	BENOA, BALI		18:00
18 Mar	DAY AT SEA		
19 Mar	SEMARANG	08:00	☾
20 Mar	SEMARANG		17:00
21 Mar	DAY AT SEA		
22 Mar	SINGAPORE	13:00	☾
23 Mar	SINGAPORE		23:00
24 Mar	DAY AT SEA		
25 Mar	KUCHING	08:00	23:00
26 Mar	DAY AT SEA		

27 Mar	KOTA KINABALU	08:00	15:00
28 Mar	DAY AT SEA		
29 Mar	HO CHI MINH CITY	08:00	☾
30 Mar	HO CHI MINH CITY		14:00
31 Mar	DAY AT SEA		
1 Apr	CHAN MAY (HUE/DANANG)	07:00	22:00
2 Apr	DAY AT SEA		
3 Apr	HONG KONG	08:00	☾
CHAPTER 5			
4 Apr	HONG KONG		☾
5 Apr	HONG KONG		14:00
6 Apr	DAY AT SEA		
7 Apr	DAY AT SEA		
8 Apr	SHANGHAI	03:00	☾
9 Apr	SHANGHAI		☾
10 Apr	SHANGHAI		16:30
11 Apr	DAY AT SEA		
12 Apr	DAY AT SEA		
13 Apr	BEIJING (TIANJIN)	07:00	☾
14 Apr	BEIJING (TIANJIN)		19:00
15 Apr	DAY AT SEA		
16 Apr	DAY AT SEA		
17 Apr	HIROSHIMA	08:00	18:00
18 Apr	OSAKA	08:00	☾
19 Apr	OSAKA		17:00
20 Apr	TOKYO	18:00	☾
CHAPTER 6			
21 Apr	TOKYO		19:00
22 Apr	DAY AT SEA		
23 Apr	AOMORI	09:00	16:30
24 Apr	OTARU	08:00	18:00
25 Apr	AKITA	13:00	23:00
26 Apr	DAY AT SEA		
27 Apr	VLADIVOSTOK	08:00	☾
28 Apr	VLADIVOSTOK		18:00
29 Apr	DAY AT SEA		
30 Apr	KORSAKOV	09:00	18:00
1 May	DAY AT SEA		

2 May	DAY AT SEA		
3 May	PETROPAVLOVSK (KAMCHATSKY)	08:00	☾
4 May	PETROPAVLOVSK (KAMCHATSKY)		17:00
5 May	DAY AT SEA		
5 May	DATE LINE GAIN A DAY		
6 May	DAY AT SEA		
7 May	DUTCH HARBOR	08:00	14:00
8 May	DAY AT SEA		
9 May	KODIAK	08:00	18:00
CHAPTER 7			
10 May	SEWARD	07:00	19:00
11 May	WHITTIER	07:00	16:00
12 May	CRUISING HUBBARD GLACIER	12:00	16:00
13 May	ICY STRAIT POINT	08:00	18:00
14 May	SITKA	08:00	18:00
15 May	TRACY ARM / SAWYER GLACIER	08:00	17:00
15 May	JUNEAU	22:00	☾
16 May	JUNEAU		17:00
17 May	WRANGELL	09:00	18:00
18 May	KETCHIKAN	08:00	18:00
19 May	PRINCE RUPERT	07:00	18:00
20 May	DAY AT SEA		
21 May	VICTORIA	09:00	23:59
22 May	VANCOUVER	07:00	☾
23 May	VANCOUVER		18:00
24 May	DAY AT SEA		
25 May	DAY AT SEA		
26 May	SAN FRANCISCO		07:00

☾ Overnight in Port

THE WORLD IS AT YOUR DOOR

Start your fantastic World Cruise journey as soon as you leave home. We bring you all the authenticity and beauty of the world's finest destinations, right to your front door, in utmost comfort. Our luxurious door-to-door service takes care of everything, including private airport transfers, VIP meet and greets, business class lounge access and much much more. We're committed to making your voyage the most enjoyable and comfortable it can be as well as exceeding your expectations at every turn. You'll get complete peace of mind right from your front door all the way to San Francisco to your World Cruise experience. Just sit back, relax and enjoy the world.

YOUR ALL-INCLUSIVE DOOR-TO-DOOR JOURNEY

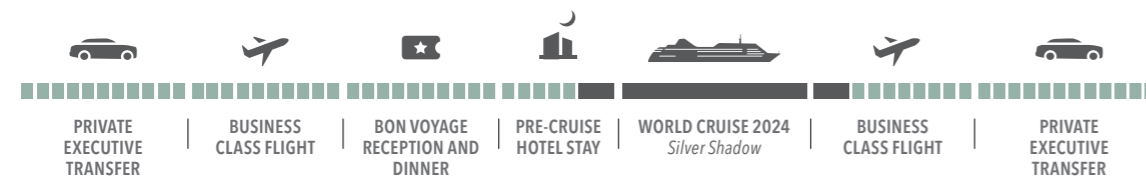



**BENEFITS & INCLUSIONS
EXCLUSIVE TO WORLD CRUISE GUESTS**

PRIVATE EXECUTIVE TRANSFERS BETWEEN HOME, AIRPORT AND SHIP*

BUSINESS CLASS AIR
(FROM SELECTED COUNTRIES/GATEWAYS)

MEET & GREET**

ACCESS TO DESIGNATED AIRLINE LOUNGES**

BON VOYAGE RECEPTION, DINNER
AND OVERNIGHT ACCOMMODATION PRE-EMBARKATION

SHORE EXCURSIONS

\$1,000 ONBOARD SPENDING CREDIT PER GUEST (UP TO \$2,000 PER SUITE)

EXCLUSIVE WORLD CRUISE EVENTS AND OVERLAND PROGRAMMES

SPECIAL COMMEMORATIVE GIFTS

COMPLIMENTARY SILVER SHORE BAGGAGE VALET (UP TO 2 BAGS, 50LBS EACH, PER GUEST)

COMPLIMENTARY LAUNDRY SERVICE

COMPLIMENTARY UNLIMITED WI-FI

MEDICAL SERVICE***

VISA PACKAGE****

*Up to 60 miles per transfer | **At selected airports | ***Medical Service includes: visits to the Ship Medical Center, medical services typically provided for which we normally charge a fee, any medical tests administered onboard and medications prescribed by our onboard doctor to treat an ailment. We will not include refills on any prescription drugs, the cost of transferring a guest to land based facility for treatment, medical evacuations, or any other costs incurred off the ship.
****USA, Canada, UK, Germany, Australia only

SILVER SHADOW - DECK PLANS

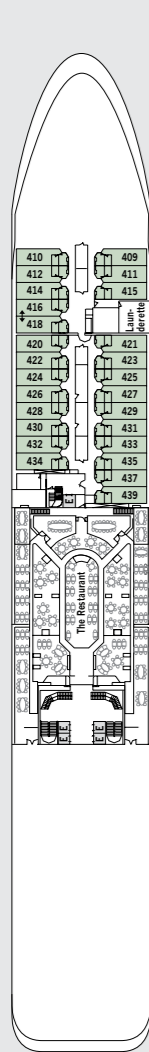

DECK 4
The Restaurant

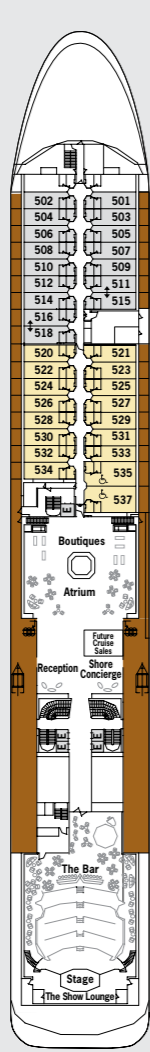

DECK 5
Boutiques
Atrium
Future Cruise Sales
Reception
Shore Concierge
The Bar
The Show Lounge

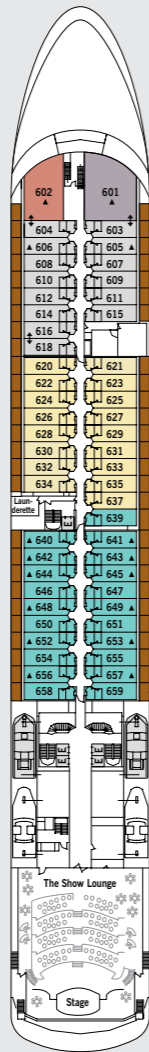

DECK 6
The Show Lounge

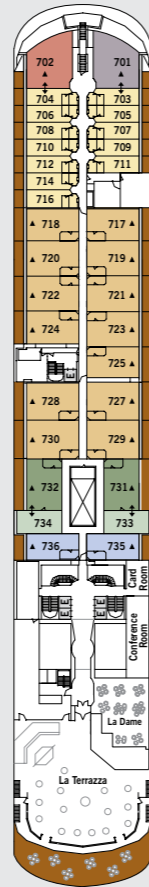

DECK 7
La Terrazza
La Dame
Conference/Card Room

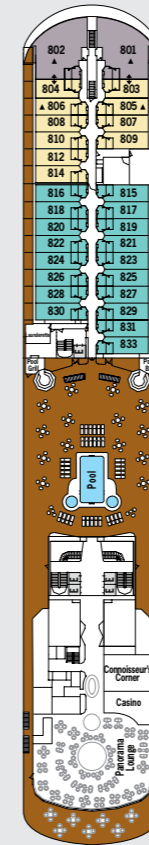

DECK 8
Pool Deck
Pool Bar
The Grill
Connoisseur's Corner
Connoisseur's Corner Outdoor area
Casino
Panorama Lounge

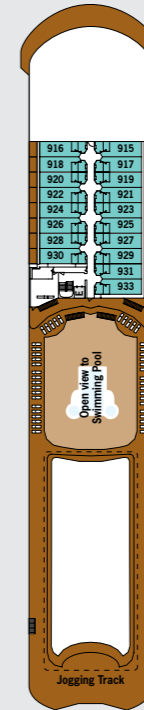

DECK 9
Jogging Track

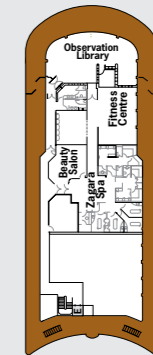

DECK 10
Fitness Centre
Zagara Beauty Spa
Observation Library

SUITE CATEGORIES

- Owner's Suite
- Grand Suite
- Royal Suite
- Silver Suite
- Medallion Suite
- Deluxe Veranda Suite
- Superior Veranda Suite
- Classic Veranda Suite
- Vista Suite



Deckplans are for illustration purposes only and may be subject to change.

SILVER SHADOW SUITES

Suite diagrams shown are for illustration purposes only and may vary from actual square footage. Please refer to suite specifications for square footage.

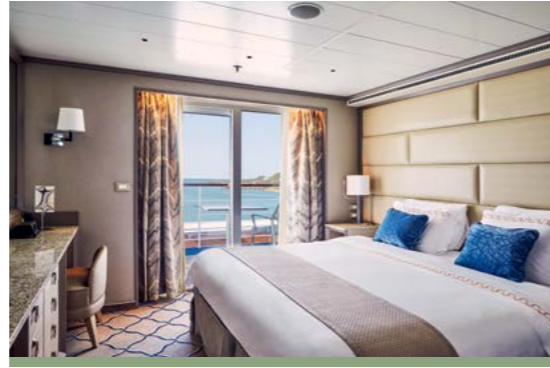

OWNER'S SUITE

Available as a one-bedroom configuration or as bedroom twos (as illustrated) by adjoining with a Vista Suite.

1 BEDROOM: 919 SQ. FT. / 85 M²
INCLUDING VERANDA (220 SQ. FT. / 20 M²);
2 BEDROOM: 1,264 SQ. FT. / 117 M²
INCLUDING VERANDA (220 SQ. FT. / 20 M²)

- Large veranda with patio furniture and floor-to-ceiling glass doors; bedroom two has additional large picture window
- Living room with sitting area; bedroom two has additional sitting area
- Separate dining area and bar
- Twin beds or queen-sized bed; bedroom two has additional twin beds or queen-sized bed
- Marble bathroom with double vanity, separate shower and full-sized whirlpool bath, plus a powder room; bedroom two has additional marble bathroom with full-sized bath
- Walk-in wardrobe(s) with personal safe
- Vanity table(s) with hair dryer
- Writing desk(s)
- 32" / 81 cm flat-screen television(s) with Interactive Media Library
- Bose® Sound system with bluetooth connectivity
- Unlimited Premium Wifi
- Illy® espresso machine



GRAND SUITE

Available as a one-bedroom configuration or as bedroom twos (as illustrated) by adjoining with a Veranda Suite.

1 BEDROOM: 941-1,090 SQ. FT. / 87-101 M²
INCLUDING VERANDA (103-116 SQ. FT. / 10-11 M²);
2 BEDROOM: 1,286-1,435 SQ. FT. / 119-133 M²
INCLUDING VERANDA (163-176 SQ. FT. / 16-17 M²)

- Large veranda with patio furniture and floor-to-ceiling glass doors; bedroom two has additional veranda
- Living room with sitting area; bedroom two has additional sitting area
- Separate dining area and bar
- Twin beds or queen-sized bed; bedroom two has additional twin beds or queen-sized bed
- Marble bathroom with double vanity, separate shower and full-sized whirlpool bath, plus a powder room; bedroom two has additional marble bathroom with full-sized bath
- Walk-in wardrobe(s) with personal safe
- Vanity table(s) with hair dryer
- Writing desk(s)
- 32" / 81 cm flat-screen television(s) with Interactive Media Library
- Bose® Sound system with bluetooth connectivity
- Unlimited Premium Wifi
- Illy® espresso machine



ROYAL SUITE

Available as a one-bedroom configuration or as bedroom twos (as illustrated) by adjoining with a Veranda Suite.

1 BEDROOM: 967-1,007 SQ. FT. / 90-94 M²
INCLUDING VERANDA (110-116 SQ. FT. / 10-11 M²);
2 BEDROOM: 1,312-1,352 SQ. FT. / 122-126 M²
INCLUDING VERANDA (170-176 SQ. FT. / 16-17 M²)

- Large veranda with patio furniture and floor-to-ceiling glass doors; bedroom two has additional veranda
- Living room with sitting area; bedroom two has additional sitting area
- Separate dining area and bar
- Twin beds or queen-sized bed; bedroom two has additional twin beds or queen-sized bed
- Marble bathroom with double vanity, separate shower and full-sized whirlpool bath, plus a powder room; bedroom two has additional marble bathroom with full-sized bath
- Walk-in wardrobe(s) with personal safe
- Vanity table(s) with hair dryer
- Writing desk(s)
- 32" / 81 cm flat-screen television(s) with Interactive Media Library
- Bose® Sound system with bluetooth connectivity
- Unlimited Premium Wifi
- Illy® espresso machine





SILVER SUITE

Silver Suites accommodate three guests.

653-701 SQ. FT. / 61-65 M²
INCLUDING VERANDA (110-123 SQ. FT. / 10-11 M²)

- Veranda with patio furniture and floor-to-ceiling glass doors
- Living room (with convertible sofa to accommodate an additional guest)
- Sitting area
- Separate dining area
- Twin beds or queen-sized bed
- Marble bathroom with double vanity, separate shower and full-sized whirlpool bath
- Walk-in wardrobe with personal safe
- Vanity table with hair dryer
- Writing desk
- 32" / 81 cm flat-screen television(s) with Interactive Media Library
- Bose® Sound system with bluetooth connectivity
- Unlimited Premium Wifi
- Illy® espresso machine



MEDALLION SUITE

Medallion Suites accommodate three guests.

521 SQ. FT. / 49 M²
INCLUDING VERANDA (81 SQ. FT. / 8 M²)

- Veranda with patio furniture and floor-to-ceiling glass doors
- Living room with sitting and dining area
- Twin beds or queen-sized bed
- Marble bathroom with double vanity, separate shower and full-sized whirlpool bath
- Walk-in wardrobe with personal safe
- Vanity table with hair dryer
- Writing desk
- 32" / 81 cm flat-screen television with Interactive Media Library
- Bose® Sound system with bluetooth connectivity
- Unlimited Premium Wifi
- Illy® espresso machine

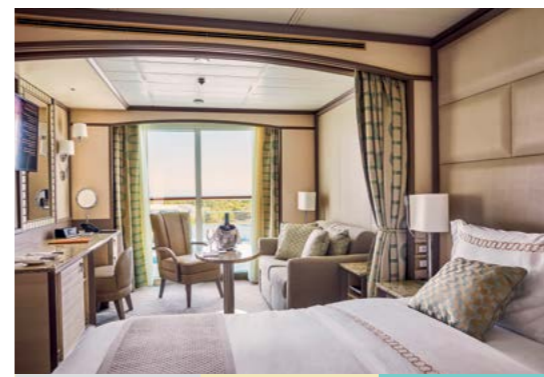

DELUXE VERANDA SUITE / SUPERIOR VERANDA SUITE / CLASSIC VERANDA SUITE

Veranda Suites 605, 606, 640-645, 648, 649, 652, 653, 656 and 657 accommodate three guests. Deluxe Verandas offer preferred central location with identical accommodations to Classic and Superior Verandas.

345 SQ. FT. / 32 M²
INCLUDING VERANDA (60 SQ. FT. / 6 M²)

- Veranda with patio furniture and floor-to-ceiling glass doors
- Sitting area
- Twin beds or queen-sized bed
- Marble bathroom with double vanity, full-sized bath, separate shower
- Walk-in wardrobe with personal safe
- Vanity table with hair dryer
- Writing desk
- 32" / 81 cm flat-screen television with Interactive Media Library
- Unlimited Standard Wifi



VISTA SUITE

287 SQ. FT. / 27 M²

- Large picture window providing panoramic ocean views (Vista Suite)
- Sitting area
- Twin beds or queen-sized bed
- Marble bathroom with double vanity, full-sized bath, separate shower
- Walk-in wardrobe with personal safe
- Vanity table with hair dryer
- Writing desk
- 32" / 81 cm flat-screen television with Interactive Media Library
- Unlimited Standard Wifi

Images are intended as a general reference. Features, materials, finishes and layout may be different than shown.



Visit silversea.com/terms-and-conditions for the full Terms and Conditions

FOR RESERVATIONS CONTACT YOUR TRAVEL ADVISOR OR SILVERSEA

ASIA	+65 6223 1846
AUSTRALIA	+1300 306 872
AUSTRIA	+43 8000 68 762
BELGIUM	+32 2 401 1432
DENMARK	+45 7014 2898
GERMANY	+49 69 2222 12283
FINLAND	+358 9 2319 5040
FRANCE	+33 1 7070 9622
IRELAND	+353 (01) 6110 560
ITALY	+39 02 3604 9211
JAPAN / KOREA	+81 (0) 3 6868 8834
LATAM	+1 888 978 2840
MONACO	+377 9770 2424
NETHERLANDS	+31 20 713 9298
NEW ZEALAND	+0800 701 427
NORWAY	+47 2103 3400
SWEDEN	+46 8 5068 5493
SWITZERLAND	+41 4458 07181
SPAIN	+34 9380 01962
UNITED STATES AND CANADA	+1 844 885 8417
UK	+44 (0) 207 340 0700

**FOR FURTHER DETAILS ON AVAILABILITY AND FARES VISIT
SILVERSEA.COM**